

# Outside

## USAGE NOTES

- The DC (3) and USB-C (4) ports cannot work simultaneously. These 2 ports are on the same circuit. Input and output cannot be used at the same time.
- It is recommended to unplug the charging cable when charging has completed.
- Recommended charging temperature: 0°C to 40°C.  
Recommended operating temperature: 0°C to 40°C.  
Use outside of these parameters risks causing irreparable damage to the battery.
- Only use the supplied charging cables.
- If the Rover Go is not in frequent use, it is recommended to recharge the Rover Go every three months.
- To avoid possible battery leakage, electric shock, fire or explosion do not use the Rover Go if water or other liquid comes into contact with the input or output ports.
- After the DC output is turned on, the output will be automatically closed after 2 hours without load. Press the power / voltage button (1) for 3 seconds to turn off the DC output manually. After pressing the power / voltage button (1) for 3 seconds, the unit will take 2 minutes to power off.
- Keep out of direct sunlight and high temperatures to avoid over heating.
- Do not dismantle, repair or alter the Rover Go in any way.
- Do not drop, vibrate or knock the Rover Go.
- Do not clean with water, use a dry cloth only.
- Stop using immediately if deformation, breakage, overheating or an abnormal odour occurs.
- Keep away from flames, smoke and hot surfaces.
- Use under adult supervision.
- Dispose and recycle in accordance with local regulations.
- This product is not recommended for powering medical emergency equipment related to personal safety, including but not limited to medical grade ventilators (hospital version CPAP: Continuous Positive Airway Pressure, artificial lungs (ECMO: Extracorporeal Membrane Usage Oxygenation). It can work normally with a home ventilator (home version CPAP), and does not have to be continuously monitored by a professional. Follow your doctor's instructions and consult with the manufacturer for restrictions on the use of the equipment. If it is used for general medical equipment, monitor the power status to ensure that the power does not run out.

5

## SPECIFICATIONS

Capacity	39,600mAh / 146.5Wh
USB-A Output	5V 3A, 9V 2A, 12V 1.5A
USB-C Input/Output	5V / 9V / 12V / 15V / 20V 3A
DC	12V 5A, 16.5V 4A, 20V 3.5A, 24V 3.5A
12V DC (CIG) Output	12-16V 10A (Max)
AC Input	20V 2A (Adapter)
Solar Input	12-24V 3A (60W Max)
Weight	0.85kg
Dimensions	185 x 121 x 40mm

## WARRANTY

- Products distributed by Adventure Operations Australia Pty Ltd and any of our subsidiaries come with guarantees that cannot be excluded under the Australian Consumer Law. You are entitled to a replacement or refund for a major failure and compensation for any other reasonably foreseeable loss or damage. You are also entitled to have the goods repaired or replaced if products fail to be of acceptable quality and the failure does not amount to a major failure.
- In addition, we warrant that this product will be free from defects in materials and workmanship under normal use as described in the published product documentation for **1 year** from the date of original purchase (Limited Warranty). This Limited Warranty is only valid and enforceable in Australia and will apply only if you have purchased the product from us or our authorised resellers.
- To the extent permitted by the Australian Consumer Law and any applicable local law:
  - our obligations under this Limited Warranty are limited to the repair, replacement or refund of covered parts that prove defective under normal use during the Limited Warranty and does not extend to any claim for damages that you or any other person may have for any loss (including without limitation consequential damages or loss of profit, freight/shipping or travel costs), or damage howsoever caused whether or not such loss or damage arises as a result of any defect in the product or from the failure or omission on our part to comply with any obligation at law;
  - in replacing a defective product under the Limited Warranty, we may, at its discretion, substitute a model of equivalent nature where the exact model is unavailable;

6

- this Limited Warranty does not apply to damage caused by failure and damage caused by improper use and abuse, fair wear and tear, accidents, misuse (including failure to follow instructions regarding care and maintenance of the product), neglect, disassembly, alterations or external causes such as, but not limited to, water damage, exposure to sharp objects, exposure to excessive force, anomalies in the electrical current supplied to the product (if applicable), and extreme thermal or environmental conditions;
  - we may elect, at our discretion and as an alternative to repairing or replacing a defective part to refund the cost of the relevant product upon it being returned to us; and
  - this Limited Warranty does not extend to any products acquired for the purposes of re-supply, or for use in a manufacturing, or repair processes.
- This warranty may be claimed by:
    - returning the product to its place of purchase, with a detailed proof-of-purchase clearly showing the date and detail of the purchase;
  - If you have any questions concerning this warranty policy, you may contact us in writing: Adventure Operations, 71 Charles Ulm Place, Eagle Farm, 4009 QLD, or by email: warranty@adventureoperations.com or visit our website www.adventureoperations.com

TO THE EXTENT PERMITTED BY LAW, ADVENTURE OPERATIONS AUSTRALIA PTY LTD, ITS SUBSIDIARIES AND ITS VENDORS DISCLAIM ANY IMPLIED WARRANTIES OF MERCHANTABILITY OR FITNESS FOR A PARTICULAR PURPOSE OR ANY SIMILAR STANDARD IMPOSED BY APPLICABLE LEGISLATION AND ADVENTURE OPERATIONS AUSTRALIA PTY LTD AND ITS SUBSIDIARIES' RESPONSIBILITY TO REPAIR, REPLACE, OR OFFER A REFUND FOR DEFECTIVE PRODUCTS IS THE SOLE AND EXCLUSIVE REMEDY PROVIDED TO ITS CUSTOMERS UNDER THIS DOCUMENT.

WARRANTY - For details see [www.companionoutdoor.com/warranty](http://www.companionoutdoor.com/warranty)

Companion® is a registered trademark of  
Adventure Trading Australia Pty Ltd

Designed by:  
Adventure Trading Australia Pty Ltd  
71 Charles Ulm Place,  
Eagle Farm, QLD 4009  
AUSTRALIA

Made in China



7

# COMPANION®

## ROVER™ GO OWNERS MANUAL

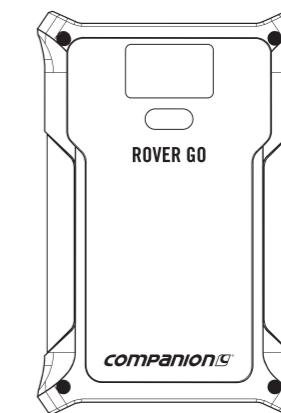

Model No. 10001548

# Inside

## PACKAGE CONTENTS

- 1 x Rover Go Portable Lithium Powerbank
- 1 x 240V AC Wall Charger
- 1 x Anderson to DC Charger
- 1 x USB-A to USB-C Charger
- 1 x USB-C to USB-C Charger
- 1 x Owners Manual
- 1 x Carry Bag

## UNDERSTANDING YOUR ROVER™ GO

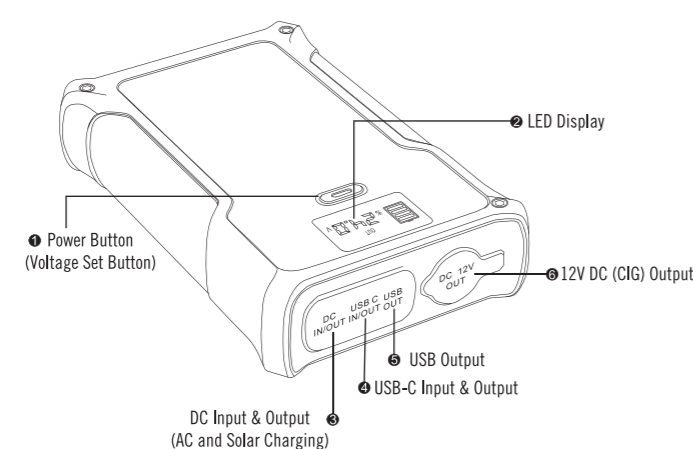

1

## RECOMMENDED SETTINGS AND PORTS FOR USE

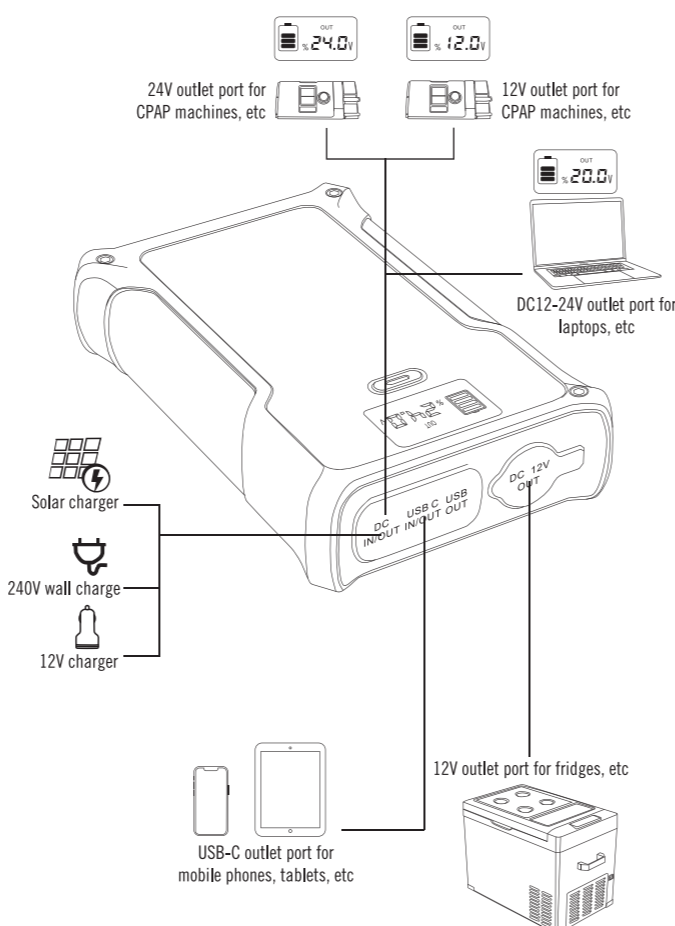

2

## CHARGING YOUR ROVER™ GO

Use the DC (3) port or USB-C (4) port to charge the powerbank.

- Charge the Rover Go via the 240V wall charger, 12V car charger (12-24V 3A max) or solar panel (max input 60W).
- The Rover Go will reach full charge in approximately 4hrs when charged via the AC wall adapter. Charging via solar will vary depending on panel power and sunlight intensity. The Rover Go will support 60W solar power (max).
- Once the Rover Go is connected to the chosen power source via DC (3) or USB-C (4), the LED display will show '1N' and the battery indicator icon will flash. Each bar on the battery represents 25% charge. When the battery display stops flashing the Rover Go is fully charged.

## LED DISPLAY

The digital display screen shows the powerbank battery level:

- One bar - 25%
- Two bars - 50%
- Three bars - 75%
- Four bars - 100% (as shown in the picture)

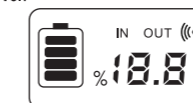

## KEY FUNCTIONS

- To power on your Rover Go, press and hold the power / voltage button (1) for 3 seconds.
- To turn off your Rover Go, press and hold the power / voltage button (1) for 3 seconds. The Rover Go will then take 2 minutes to shut off.
- The Rover Go will automatically shut off after 2 hours of inactivity. Inactivity occurs when no input or outputs are recognized.

## CHARGING

- USB (5) and USB-C (4) are suitable for charging mobile phones, tablets and other digital devices.
- The Rover Go will automatically charge devices when connected to the USB and USB-C outputs. If the device is not charging, check the cables and connections and short press the power button (1).

3

## POWERING OTHER DC INPUT DEVICES

- Prior to charging or using a DC device, it is important to ensure that the correct cable and output port is being used.
- The Rover Go can operate at 4 different voltage outputs; 12V, 16.5V, 20V and 24V. Prior to connecting a DC device, set the correct voltage output. To set voltage, long press the power / voltage button (1) for 3 seconds. The voltage on the digital display (2) will flash and stay on each voltage setting for 5 seconds. To choose the desired voltage short press the power / voltage button (1) to scroll through the settings.
- Once the desired voltage has been selected and it has stopped flashing (5 seconds) the DC (3) port is working. The DC (3) output will be shut down if there is no connection within 2 hours.
- The DC (3) port is suitable for powering CPAP machines, laptops and other devices.

## Readjust the working voltage:

- Press power button (1) for 3 seconds to turn off the output. Press and hold for 3 seconds to adjust the voltage.
- Long press the power button (1) adjustment button again to select the working voltage when the display voltage flashes.

## 12V DC (CIG) OUTPUT

- The Rover Go will support the following 12V devices (among others): portable fridge / freezers, inflators and pumps, work and camp lights / fans and any other 12V devices under 150W.
- Connect the device to the 12V DC (cig) output socket (3).
- The output will automatically power the connected device.
- To turn off the device, simply unplug it from the 12V DC (cig) port.

Note: The working voltage of the cigarette lighter is 12-16.8V. Some devices will automatically protect against startup if the starting voltage is slightly lower than the highest voltage of the Rover Go 12V DC (cig) socket when fully charged. If the device cannot be powered, slightly discharge the Rover Go and retry.

4