

FCC WARNING

This equipment complies with FCC radiation exposure limits set forth for an uncontrolled environment. This equipment should be installed and operated with minimum distance 20cm between the radiator & your body.

Any changes or modifications not expressly approved by the party responsible for compliance could void the user's authority to operate the equipment.

Note: This equipment has been tested and found to comply with the limits for a Class B digital device, pursuant to part 15 of the FCC Rules. Operation is subject to the following two conditions:

- (1) This device may not cause harmful interference, and
- (2) this device must accept any interference received, including interference that may cause undesired operation.

These limits are designed to provide reasonable protection against harmful interference in a residential installation. This equipment generates uses and can radiate radio frequency energy and, if not installed and used in accordance with the instructions, may cause harmful interference to radio communications. However, there is no guarantee that interference will not occur in a particular installation. If this equipment does cause harmful interference to radio or television reception, which can be determined by turning the equipment off and on, the user is encouraged to try to correct the interference by one or more of the following measures:

- Reorient or relocate the receiving antenna.
- Increase the separation between the equipment and receiver.
- Connect the equipment into an outlet on a circuit different from that to which the receiver is connected.
- Consult the dealer or an experienced radio/TV technician for help.

DOWNLOAD THE APP



Ultimate9 TC



Available for iOS and Android via the App Store and Google Play, the Ultimate9 Throttle Controller App allows you to control and adjust the evcX remotely and via a larger screen for ease of use. Search Ultimate9 TC or alternatively, scan the QR code below with your device's camera to download the app.

CONTACT US



+61 3 8740 1170



www.ultimate9.co



sales@ultimate9.co



facebook.com/ultimate9



@ultimate9_

Copyright Ultimate9® © 2022

HOW TO

Use the App to control the evcX

Choose either Launchpad or Wheel themes for easy control of your evcX. With customisable colors to complement your vehicle dash board lights, the larger display of your mobile device makes selecting modes simple with easy to read buttons.

Using the Lock feature

The evcX has a throttle lock feature that can be selected from within the app or the driver interface. Once locked, the driver interface can be removed from the vehicle, rendering the throttle inoperable. A 4 digit code can also be set, so that only drivers with the code can re-enable the throttle, adding an extra level of anti-theft security.

Overtaking

Unleash the power of your engine for overtaking and reduce throttle lag by setting the evcX to Ultimate mode and fine tuning from settings 1-9. For instant maximum throttle response, set the evcX to Ultimate9 mode.

Controlled take off

Use Launch mode for fast acceleration from a standing start whilst maintaining traction.

Efficient throttle control

Set the evcX to either Eco mode or Adapt mode. This ensures efficient use of the throttle which may result in fuel savings.

HOW TO

Control when towing

Experiencing wheel spin on the boat ramp, or need more control when backing and parking the van? Set your evcX to Eco mode for a reduced throttle response, allowing the vehicle to ease off the mark with reduced wheel spin or to back a van gently into position.

Mud, sand & loose surfaces

Anti-Slip mode can help reduce wheel spin on soft or loose surfaces such as mud and sand, enhancing available traction.

Control off road

High settings in Eco mode are perfect for low range 4WD driving where the dampened throttle response offers more control over undulating terrain preventing unnecessary bouncing.

Ultimate response

Need quick bursts of acceleration to get you out of a sticky situation? Use higher settings in Ultimate mode for greater throttle response.

Loaning your vehicle

You may be sharing your vehicle with a learner or inexperienced driver. For those unfamiliar with using the evcX, set to Factory mode to return throttle operation to standard.

FAQ'S

How does the evcX work?

The evcX Throttle Controller modifies the voltage signal from the fly-by-wire pedal assembly to allow you to adjust and fine tune the response from the accelerator pedal and reduce throttle lag. The evcX plugs directly into the pedal assembly using factory style plugs and requires no vehicle modifications.

Will the evcX work with other modifications?

The evcX is designed to work seamlessly with your vehicle and has been tested with various aftermarket products:

Cruise Control - the evcX has not been found to effect any aftermarket cruise control systems.

ECU Tune/Remap - The evcX can be used with an ECU Tune/Remap, the adjustability of the evcX will compliment the increased performance of the tune.

Power Chips/Exhaust - evcX Throttle Controllers operate independently of power chips and are therefore a great addition for any performance chip and exhaust upgrades.

Why does my evcX interface remain on/turn off?

The evcX utilises power supplied through the vehicle's throttle loom. It is normal for the evcX interface to remain on for some time after engine shuts down, or to power off when the throttle is inactive, such as when using cruise control. Whilst driving, the evcX interface will power on instantly as the throttle senses driver input and when the engine is shut down it will usually power off within 30 seconds or when the vehicle central locking is activated.

TROUBLESHOOTING

Each evcX is manufactured with durability and performance in mind and designed for simple DIY plug & play installation. If after you read these instructions you feel that installation is beyond your skill level, please contact Ultimate9 customer support or your place of purchase for recommended installers. Alternatively, your local mechanic or auto electrician is capable of completing installation for you. A typical installation will take less than 15 minutes.

If you experience any issues with an evcX Throttle Controller, such as loss of power, engine fault light illumination on dash board, fluctuating throttle response etc, these can usually be traced to a loose or damaged connection. Disconnect all evcX connector plugs and inspect the electrical pins and cables for any damage (ie. bent, broken, corrosion). If no obvious issues are found, re-install the evcX as per the instructions. Start the vehicle and check for correct operation.

If the evcX Throttle Controller continues to cause any of the above issues, please disconnect the evcX unit and return the vehicle to standard configuration. Contact Ultimate9 technical support (refer Contact Us page) to arrange a replacement unit. Please do not try to modify or repair an evcX Throttle Controller as this will void the warranty.

WARRANTY



Your Ultimate9 evcX Throttle Controller is backed by a 30 day money back guarantee. If you are not completely satisfied with the results, please return your evcX to the place of purchase within 30 days for a full refund.

Ultimate9 provides to the original purchaser, a limited lifetime replacement warranty against manufacturing faults or defects. Conditions resulting from normal wear & tear, modification, miss-use, abuse or incorrect fitment are not covered and will void the warranty. In order to make a claim under this warranty, the purchaser must:

- Return the product to the place of purchase with a valid receipt/invoice or proof of purchase **or** contact Ultimate9 customer service on 03 8740 1170
- Provide Ultimate9 with any additional information as requested.

The purchaser is responsible for any return freight or fitting/removal costs incurred when making a claim under this warranty unless communicated otherwise by Ultimate9. This warranty is limited to the original purchaser and is not transferable.

Our goods come with guarantees that cannot be excluded under the Australian Consumer Law. You are entitled to a replacement or refund for a major failure and compensation for any other reasonably foreseeable loss or damage. You are also entitled to have the goods repaired or replaced if the goods fail to be of acceptable quality and the failure does not amount to a major failure.



QUICK START GUIDE

www.ultimate9.co



INTRODUCTION

Congratulations on your purchase of an Ultimate9 evcX Throttle Controller. This Quick Start Guide allows you to self install and set up your evcX to unleash the power of your engine and eliminate throttle lag. However if you decide not to install yourself please contact Ultimate9 or your place of purchase for a recommended installer in your area.

The evcX Throttle Controller has been thoroughly tested to ensure it will not adversely effect your vehicle or void new car warranty. If you have any questions concerning the performance or suitability of the product please contact Ultimate9 or your place of purchase.

INSTALLATION

Prior to installation, ensure the vehicle ignition is switched off. Allow 10 minutes before proceeding to ensure the vehicle electronics have powered down. This will reduce the likelihood of creating an engine fault code.

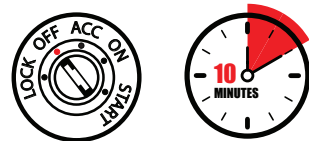

NOTE: For vehicles with push button start feature, ensure the key fob is moved >10m away from the vehicle so as not to activate accessory power.

INSTALLATION

Locate the pedal assembly and the factory plug (usually on the top of the pedal assembly). Disconnect the factory plug . It may be necessary to remove the pedal assembly if access is limited.

Note: The plug on your evcX and pedal assembly may differ from the illustration. Take care to not damage the locking clip. Plugs should be removed by hand without the need for tools.

- Factory connector plug
- Pedal assembly
- evcX unit

Orientate the male & female ends of the evcX unit so that they match the factory loom and plugs.

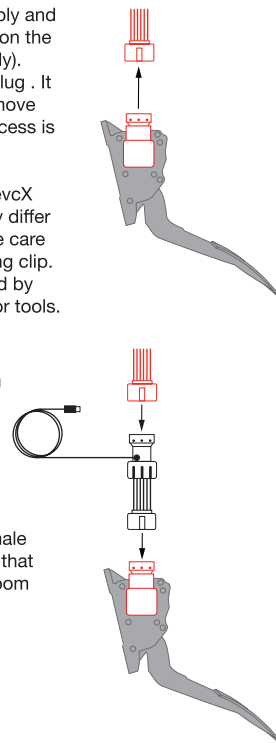

INSTALLATION

Connect the evcX unit in-line between the factory plug and pedal assembly. Ensure the plugs are aligned correctly to prevent damage to the internal pins.

Locate a suitable position on the dash or console for the evcX driver interface. Be aware that the LED display is bright and should be positioned so as not to distract the driver. Route the cable so as not to cause any obstruction. The interface has removable rubber plugs that allow the USB-C plug to be fitted on either side to facilitate mounting in various locations.

An optional magnetic ball-head mount is available for easy removal of the interface from the vehicle when in Lock mode, helping prevent vehicle theft. This can be attached to the dashboard in any location and allows for adjustment of viewing angle. Profile cut adhesive tape is supplied for permanent mounting.

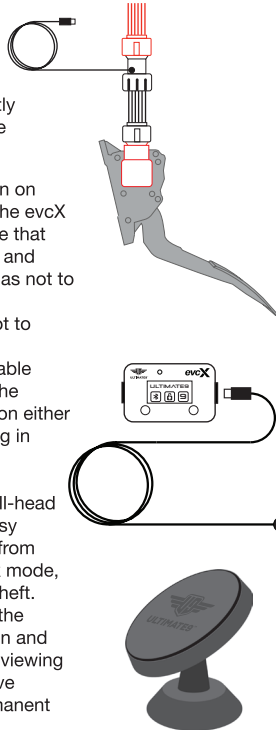

DRIVER INTERFACE

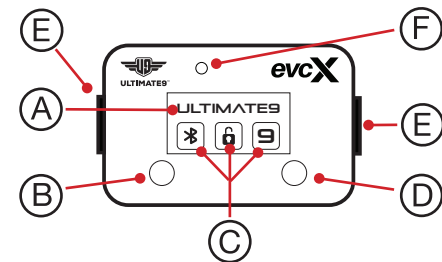

- (A)** Mode indicator: Shows current operating mode. Choose from 9 modes.
- (B)** Mode selector button: Press to cycle through modes.
- (C)** Setting indicators: Shows Bluetooth connection, lock mode status, current level setting.
- (D)** Setting selector button: Press to fine tune level within the mode. Cycles through level 1-9 dependent on mode selected.
- (E)** USB-C ports: Fit cable on either side of interface for additional mounting options. Includes rubber plug.
- (F)** Day/night sensor: Sets display brightness for day or night depending on lighting conditions.

BLUETOOTH CONNECTION

Start the vehicle.

For safety, ensure the vehicle is in Neutral (manual transmission) or Park (automatic transmission) and that the Park Brake is on.



Hold down both the selector buttons simultaneously to display the evcX ID number.

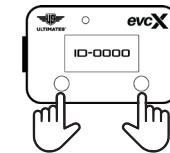

Open the Ultimate9 TC App and navigate to the Device Connect page, accessed by clicking on the menu in the top left of the screen, then selecting 'Device Connect'. From this screen, the 4 digit ID code may be entered manually. Alternatively, scan the barcode on the device to auto fill.



APP SETTINGS

NOTE: For detailed information on how to pair, set, adjust & lock the evcX via the app, please refer to the separate Throttle Control App Guide included with the evcX.

The App Settings menu is used to change and set the following features:

Interface style - Choose either launchpad or wheel mode selector designs

Interface color - Choose either dark or light themes, with blue, orange or red colored buttons

Reset - Return to factory settings

Lock - Locks and unlocks the evcX Throttle Controller for increased security

Transmission - Select either Manual or Automatic to suit your vehicle transmission type

App Version - Notifies the current version in use.

Update Version - Select to update the App and hardware to the latest version. Insure throttle controller is powered on during update and that the app is connected via Bluetooth.

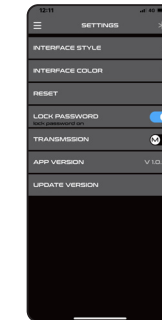

MANUAL SETTINGS

To enter the setting menu, hold the Mode button down until the menu opens.

Transmission: To set the transmission type, scroll to AT-MT. by pressing the Mode button. Press the Set button to switch between MT (manual transmission) & AT (automatic transmission).

Lock: To lock or unlock the throttle, scroll to Nlock by pressing the Mode button. Use the Set button to choose between Lock and Nlock (unlock)

To Save settings, use the Mode button to scroll to Quit. Press the Set button to save and exit.

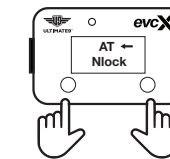

OPERATING MODES

The evcX has 9 modes that not only enhance the driving experience but also increase safety and security, both whilst the vehicle is moving and stationary

ULTIMATE9 MODE: Sets the evcX to the highest Ultimate setting - 9, unleashing the full potential of your engine.

ULTIMATE MODE: For enhanced throttle response, choose from 9 available settings to fine tune your throttle.

OPERATING MODES

LAUNCH MODE: Fast response whilst maintaining traction.

ADAPT MODE: Adapt automatically chooses the Ultimate throttle response based on the amount of pedal pressure/input from the driver.

ECO MODE: Dampens initial throttle response for greater control on loose or uneven surfaces such as when off road. Choose from 9 available settings.

ANTI-SLIP MODE: For smooth acceleration. Perfect for wet and slippery surfaces such and mud and ice. Choose from 9 available settings.

FACTORY MODE: Designed to replicate the factory throttle settings - ideal for sharing the vehicle with an unfamiliar driver.

VALET MODE: Slow acceleration with a maximum of half throttle suitable for parking/valet use in congested areas.

LOCK MODE: Set to Lock mode and remove the evcX driver interface from the vehicle to render the throttle inoperable, helping to prevent theft or unauthorised vehicle use.

UNLOCK: Used to unlock and enable the throttle pedal after locking.